

Velocitykvm-28

Multi-Mode Fiber Extension – DVI Two Display

QUICK START GUIDE

Each Thinklogical™ Velocitykvm-28 Multi-Mode Fiber Optic System consists of a transmitter unit and a receiver unit connected by four multi-mode fiber optic cables (or by one optional single-mode fiber). The transmitter unit connects to the computer with standard cables and the receiver unit provides connections to the user interface devices. The Velocitykvm-28 supports PS/2, full duplex stereo audio, serial (RS-232), USB 1.0 (HID) device ports and USB 1.1. Options include USB 2.0 (high speed up to 480Mbps).

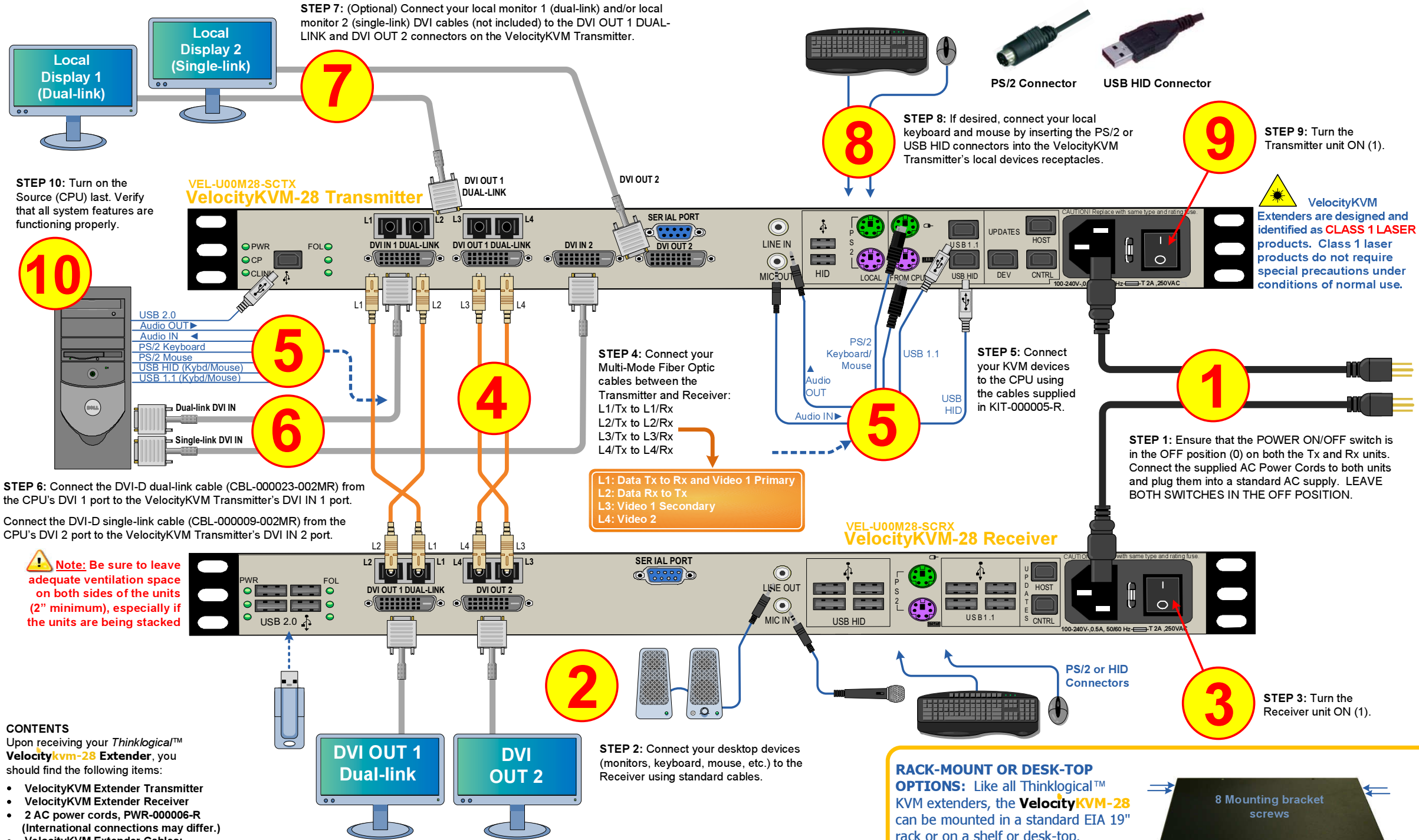

STEP 10: Turn on the Source (CPU) last. Verify that all system features are functioning properly.

STEP 6: Connect the DVI-D dual-link cable (CBL-000023-002MR) from the CPU's DVI 1 port to the VelocityKVM Transmitter's DVI IN 1 port. Connect the DVI-D single-link cable (CBL-000009-002MR) from the CPU's DVI 2 port to the VelocityKVM Transmitter's DVI IN 2 port.

Note: Be sure to leave adequate ventilation space on both sides of the units (2" minimum), especially if the units are being stacked.

- CONTENTS**
Upon receiving your Thinklogical™ Velocitykvm-28 Extender, you should find the following items:
- VelocityKVM Extender Transmitter
 - VelocityKVM Extender Receiver
 - 2 AC power cords, PWR-000006-R (International connections may differ.)
 - VelocityKVM Extender Cables:
 - 1 DVI-D Male Single-link Cable, 2 meters, CBL-000009-002MR
 - 1 DVI-D Male Dual-link Cable, 2 meters, CBL-000023-002MR
 - 1 Cable Kit (8 six ft. peripheral cables.) KIT-000005-R
 - VelocityKVM Extender Product Manual

All physical connections to the product use industry-standard connectors.

VelocityKVM Extenders are designed and identified as CLASS 1 LASER products. Class 1 laser products do not require special precautions under conditions of normal use.

RACK-MOUNT OR DESK-TOP OPTIONS: Like all Thinklogical™ KVM extenders, the VelocityKVM-28 can be mounted in a standard EIA 19" rack or on a shelf or desk-top.

Each mounting bracket is secured by four screws and can be safely removed from the transmitter or receiver unit for desk-top mounting after power has been removed from the unit. All screws should be reinstalled after the brackets have been removed.

thinklogical™
PHONE: (800) 291-3211
WEBSITE: www.thinklogical.com
EMAIL: support@thinklogical.com

Visit us online at www.thinklogical.com for more product information, current updates and the complete line of Thinklogical™ products.